

CARACTERÍSTICAS / FEATURES

Material hormigón Petra 1
Acabado decapado e hidrofugado
Dimensiones l. 170, a. 163, h. 45 cm
Color ver carta de colores
Fijación apoyado por su propio peso
Peso 1230 Kg
Palet 180 x 180 cm

Material precast concrete Petra 1
Finish scaled and waterproofed
Dimensions l. 170, w. 163, h. 45 cm
Colour see colour catalogue
Fixing resting on the ground
Weight 1230 Kg
Pallet 180 x 180 cm

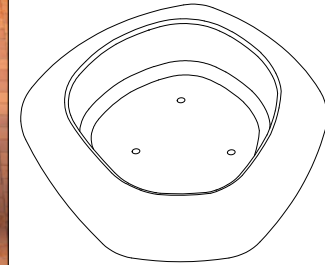

GEOMETRIA / GEOMETRY

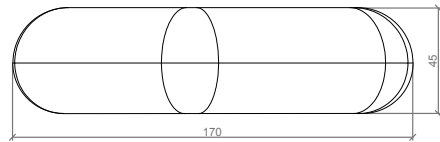

ALZADO / FRONT VIEW

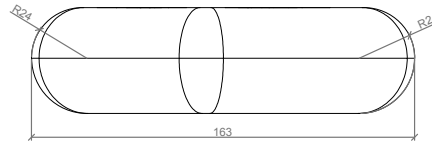

PERFIL / PROFIL VIEW

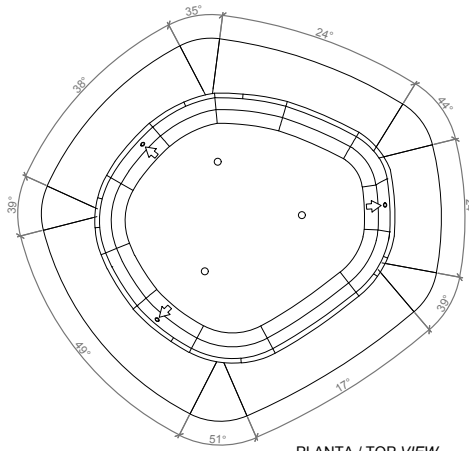

PLANTA / TOP VIEW

Ubicación del casquillo roscado
Location of steel socket threaded

ESC. 1:20

ESPECIFICACIONES / SPECIFICATIONS

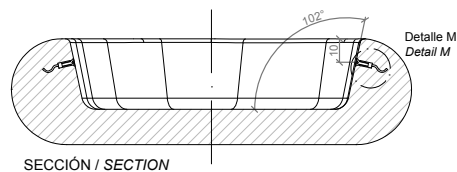

SECCIÓN / SECTION

Casquillo M16 - Tubo acero zincado alta precisión
Galvanized steel threaded sleeve high precision

Tornillo avellando M16 - Inox
Countersunk screw M16 - Inox

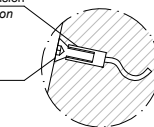

DETALLE M / DETAIL M
Casquillo de elevación / Lifting sleeve

MANIPULACIÓN E INSTALACIÓN / HANDLING AND INSTALLATION

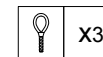
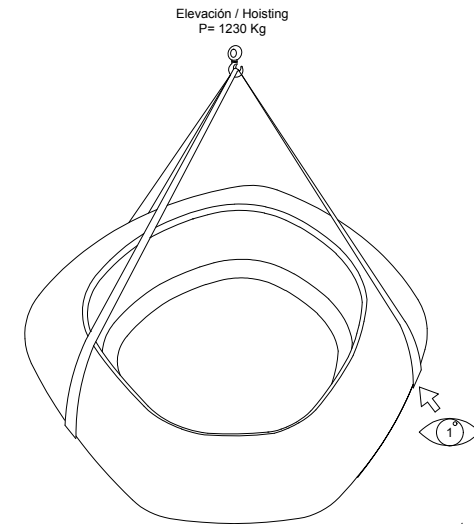

DETALLE 1 / DETAIL 1