

**CARACTERÍSTICAS / FEATURES**

**Material** hormigón piedra2  
**Acabado** decapado  
**Dimensiones** Ø45, h. 103 cm.  
**Color** ver carta de colores  
**Fijación** simplemente apoyado o mediante varillas metálicas  
**Peso / Capacidad:** 119 Kg / 70 L  
**Bulto** 120 x 100 x 120 cm [ 5u / bulto ]  
**Peso bulto** 610 Kg

**Material** precast concrete *petra2*  
**Finish** *scaled*  
**Dimensions** Ø45, h. 103 cm.  
**Colour** *see colour catalogue*  
**Fixing** *resting on the ground & or anchored with metal rod*  
**Weight / Capacity** 119 Kg / 70 L  
**Package** 120 x 100 x 120 cm [ 5u / bulto ]  
**Weight package** 610 Kg



**GEOMETRIA / GEOMETRY**

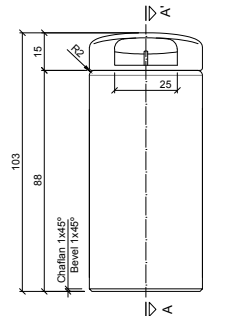

ALZADO / FRONT VIEW

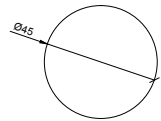

PLANTA / TOP VIEW

**SET / CONJUNTO**

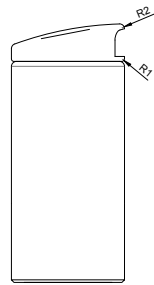

PERFIL / PROFIL VIEW

**ACCESORIO / ACCESSORIES**

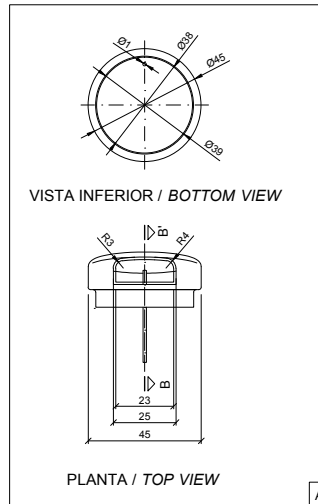

VISTA INFERIOR / BOTTOM VIEW

PLANTA / TOP VIEW

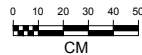

**MANIPULACIÓN E INSTALACIÓN / HANDLING AND INSTALLATION**

1 Perforar agujero y verter resina epoxy dentro / Drill hole and pour resin epoxy inside hole

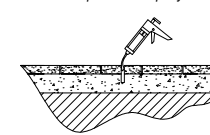
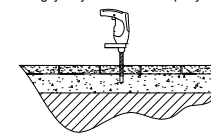

2 Posicionar la varilla en el agujero central y fijar con tuercas hexagonales / Place the threaded rod into the center hole and fix with nut hexagonal

3 Insertar varilla roscada en agujero / Insert metal threaded rod in hole

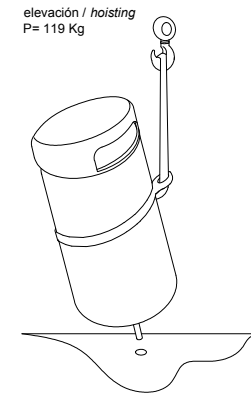
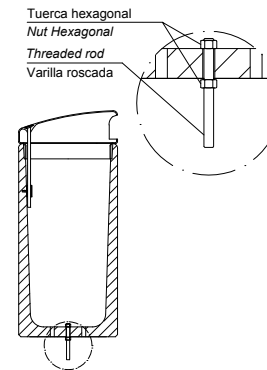

**ESPECIFICACIONES / SPECIFICATIONS**

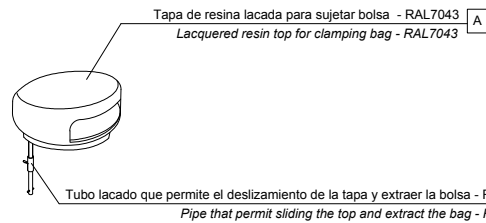

DETALLE ACCESORIO / DETAIL ACCESSORIES

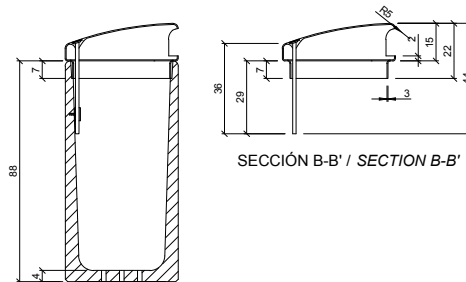

SECCIÓN A-A' / SECTION A-A'

SECCIÓN B-B' / SECTION B-B'

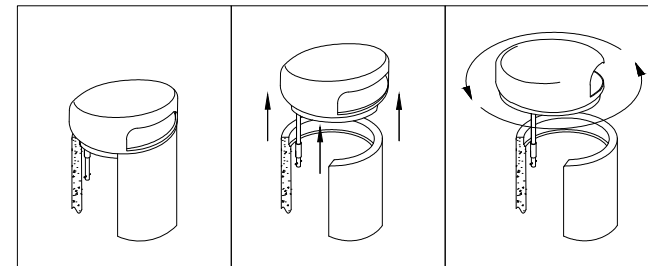

DETALLE DE EXTRACCIÓN BOLSA / DETAIL OF HOW EXTRACT BAG